



MARIANO MARCOS STATE UNIVERSITY

Bids and Awards Committee

INVITATION TO MAKE AN OFFER: Negotiated Procurement

2022-021

THE PROJECT: Glass Partition of Office for Strategic Communication

Number of Working Days: 30 calendar days

ABC: P210,696.00

1. The Mariano Marcos State University (MMSU), with offices at Quiling Sur, City of Batac, Ilocos Norte, invites the public to make an offer to furnish all labor, materials, tools and equipment necessary and proper for the implementation of the above Project as per approved designs, plans and drawings.
2. This process is in accordance with Section 53 of R.A. 9184, the Government Procurement reform Act and Section 53.9 of the Implementing Rules and Regulations where interested and qualified contractors are to submit proposals.
4. The offer must be in writing submitted at the address below not later than **5 days** together with the following documents:
 - a) The amount of the offer in writing duly signed by the person making the offer, indicated in numbers and figures.
 - b) The particulars of the offer as to labor, materials, tools, equipment and other work details.
 - c) Documents in support of the legal, technical and financial capability of the person making the offer, which documents shall be confirmed and verified (**3 copies**).
5. It is understood that any offer may be accepted or rejected, or the process invalidated, at any time prior to contract award, without liability to anyone.
6. Documents for this procurement may be secured from the MMSU BAC Secretariat at the address below or downloaded from the MMSU website or from the Philippine Government Electronic Procurement System (PhilGEPS) website.
7. For questions and inquiries, please write or email the University President, thru the BAC Chair, at the address indicated below.

Mariano Marcos State University
Quiling Sur, City of Batac
www.mmsu.edu.ph

August 26, 2022



NATHANIEL R. ALIBUYOG
BAC CHAIR

Received: _____

Received: _____

Received: _____

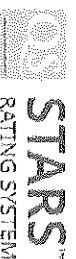
Rm 105 FEM Hall, MMSU, #16S Quiling Sur, City of Batac, Ilocos Norte
✉ bac@mmsu.edu.ph ☎ (077) 600-0459 www.mmsu.edu.ph



Republic of the Philippines
MARIANO MARCOS STATE UNIVERSITY
PHYSICAL PLANNING AND DEVELOPMENT OFFICE
City of Batac, 2906, Ilocos Norte

Glass Partition of Office for Strategic Communication
MMSU Batac Campus, City of Batac, Ilocos Norte

| SPECIFICATIONS | |
|---|--|
| Building Part / Material | Specifications |
| GLASS DOOR WITH GLASS WALL PARTITION | 10mm Thick Glass Aluminum Frame (Frosted Sticker Design) |

Republic of the Philippines
MARIANO MARCOS STATE UNIVERSITY
PHYSICAL PLANNING AND DEVELOPMENT OFFICE
City of Batac, 2906, Ilocos Norte

Glass Partition of Office for Strategic Communication
(MMSU Batac Campus, City of Batac, Ilocos Norte)

| BILL OF QUANTITIES | | | |
|---------------------------|--|----------|------|
| Item No. | Description | Quantity | Unit |
| PART A | GLASS PARTITION | 1.00 | lot |
| | 10mm Fixed Glass Wall Partition with Frosted Sticker (3.35m x 3m) (see details) | 1.00 | set |
| | Sliding Glass Door (2.1m x 1.8m) and 10mm Fixed Glass Wall Partition with Frosted Sticker (5.65m x 3m) (see details) | 1.00 | set |
| | Sliding Glass Door (2.1m x 1.8m) and 10mm Fixed Glass Wall Partition with Frosted Sticker (3.70m x 3m) (see details) | 1.00 | set |
| | Frameless Double Action Glass Door (2.1m x 1.0m) and 10mm Fixed Glass Wall Partition with Frosted Sticker (3.70m x 3m) (see details) | 1.00 | set |

PROJECT INFORMATION DOCUMENT

Project Title : Glass Partition of Office for Strategic Communication
Project Location : MMSU CRL, City of Batac, Ilocos Norte

GENERAL INSTRUCTIONS

The project calls for the furnishing of all materials, labor, tools and equipment needed for the glass door and glass wall partitioning. The said project shall be done in strict conformity with the designs, plans, drawings and other details, as well as the specifications, this Project Information Document and other related contract documents prepared and approved for this project. It is highly recommended that the contractor conduct site inspection for them to have an idea on the existing condition of the site.

It also calls for the employment of manpower with the appropriate skills and expertise to undertake the specific items of work and to enable the contractor to produce and deliver to the satisfaction of the owner the needed services and output required of this undertaking. The contractor shall provide competent project in charge (architect/civil engineer) and shall have adequate and readily available construction equipment to be utilized during the construction activities.

The contractor shall ensure that the construction activities must not interfere, obstruct and disturb any on-going operation of the building and other facilities; hence, the contractor shall isolate the working area from the other portions of the building. In addition, the contractor shall be required to provide its own power supply system needed in the proper execution of the various works for the duration of the contract.

- I. GLASS DOOR WITH GLASS WALL PARTITION – This item shall consist of furnishing of all materials, hardware, tools, labor and services necessary for the fabrication, delivery and installation of glass wall partition and aluminum glass door in the POW, specifications and drawings of the project.

Supplementary Provisions

All other items or scope of works not mentioned in this document but show/or indicated in the plans, drawings and specifications, except where it is specifically mentioned as “to be provided by others” the contractor shall likewise furnish all materials, labor and equipment necessary to complete the work.

In case of conflicts that will arise among the specifications and quality of materials, installation procedure and in the plans and drawings as well as in the other contract documents before and during the implementation stage, the same should be referred to the end-user and PPDO Project-in-Charge in proper resolution of the said conflicts.

After all the works have been completed, the surrounding immediate areas affected in the prosecution of the project shall be cleaned and cleared of all excess materials and debris, temporary structures, facilities and utilities used during the construction period.

- A. Time is a very important factor in the implementation of this project and as such, all works indicated in the plans, specifications and in this document shall be fully completed within **30 calendar days** from receipt of the Notice to Proceed.
- B. Before final acceptance by the end-user, the Contractor shall post a warranty security in accordance with the following schedule as prescribe in Section 62.2.3.3 of RA 9184

PROJECT INFORMATION DOCUMENT

Project Title : Glass Partition of Office for Strategic Communication
Project Location : MMSU CRL, City of Batag, Ilocos Norte

| Form of Warranty Security | Amount of Warranty Security (Equal to percentage of the Total Contract Price) |
|--|---|
| a) Cash or Letter of Credit issued by a Universal or Commercial Bank: Provided, however, that the LC shall be confirmed or authenticated by a Universal or Commercial Bank, if issued by a foreign bank. | Five percent (5%) |
| b) Bank guarantee confirmed by a Universal or Commercial Bank. | Ten percent (10%) |
| c) Surety bond callable upon demand issue by GSIS or a surety or insurance company duly certified by the Insurance Commission as authorized to issue such security. | Thirty percent (30%) |

to cover warranty against structural defects to cover the following periods as follows in accordance with Section 62.2.3.2

- C. Permanent Structures (15 years)
 - D. Semi-Permanent Structures (5 years)
 - E. Other Structures (2 years)
- C. The Approved Budget for the Project to be bid is **Two Hundred Ten Thousand Six Hundred Sixty Six Pesos Only (Ph.p. 210,696.00)**

Prepared by:

JEREMIAH ROGER P. CALUYA
 Civil Engineer

Checked by:

AIDA V. CABANG
 Chief, Physical Planning Section

Noted by:

ROMEO K. MUEBLIAO
 Director/PPDO

Republic of the Philippines
MARIANO MARCOS STATE UNIVERSITY
 City of Batang, 2906, Ilocos Norte

DETAILED ESTIMATES

| ITEM NUMBER | DESCRIPTION | QUANTITY | UNIT | UNIT PRICE | lot | Total Price |
|-------------|--|----------|------|--------------------------|-----|-------------|
| 1 | Glass Partition | | | | | 1,00 |
| | GLASS DOOR WITH GLASS WALL PARTITION | | | | | |
| | 10mm Fixed Glass Wall Partition with Frosted Sticker (3.35m x 3m) (see details) | | set | | | - |
| | Sliding Glass Door (2.1m x 1.8m) and 10mm Fixed Glass Wall Partition with Frosted Sticker (5.65m x 3m) (see details) | | set | | | - |
| | Sliding Glass Door (2.1m x 1.8m) and 10mm Fixed Glass Wall Partition with Frosted Sticker (3.70m x 3m) (see details) | | set | | | - |
| | Frameless Double Action Glass Door (2.1m x 1.0m) and 10mm Fixed Glass Wall Partition with Frosted Sticker (3.70m x 3m) (see details) | | set | | | - |
| | NOTE: Includes Fabrication and Installation Cost | | | | | |
| | Total Materials Cost | | | Sub-Total: Unit Cost: | | - |
| | | | | | | |
| | EQUIPMENT COST | | | | | |
| | | | | | | |
| | | | | Sub-Total: Unit Cost: | | - |
| | | | | | | |
| | LABOR COST | | | | | |
| | | | | | | |
| | | | | | | |
| | | | | Sub-Total: Unit Cost: | | - |

DIRECT COST: -
 UNIT COST: -

Plus Indirect Cost:
 OCM
 CP
 VAT
 INDIRECT COST: -
 INDIRECT UNIT COST: -

Total Direct and Indirect Cost: -



JEREMIAN ROGER P. CALUYA
CIVIL ENGINEER I

AIDA V. CABANG
ARCHITECT IV, CHIEF-PHYSICAL PLANNING SECTION

ROMEO R. DULAYLAO
DIRECTOR, PPA

SHIRLEY C. AORUPIS
UNIVERSITY PRESIDENT

PREPARED BY:

CHECKED/REVIEWED BY:

RECOMMENDING APPROVAL:

APPROVED BY:

EMIR JAN M. MATEO
ARCHITECT / DRAFTSMAN II

LOCATION: MMSU - FEM HALL BUILDING, CITY OF BATAO, ILOCOS NORTE

HERDYL L. YUMUL
DIRECTOR, OFFICE FOR STRATEGIC COMMUNICATION

GLASS PARTITION OF OFFICE FOR STRATEGIC COMMUNICATION

AS SHOWN

PROJECT TITLE:

CONFORME:

SHEET CONTENT:

SHEET NO.

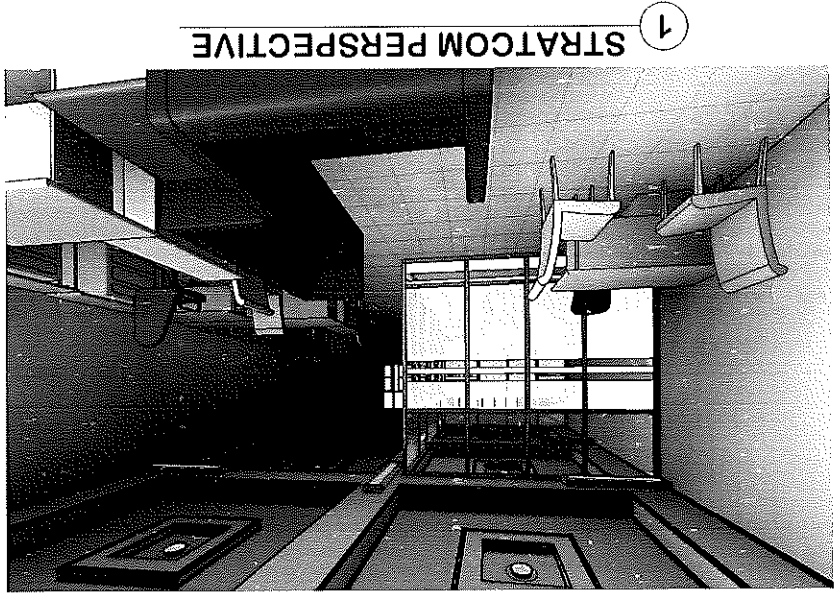

1 STRATCOM PERSPECTIVE

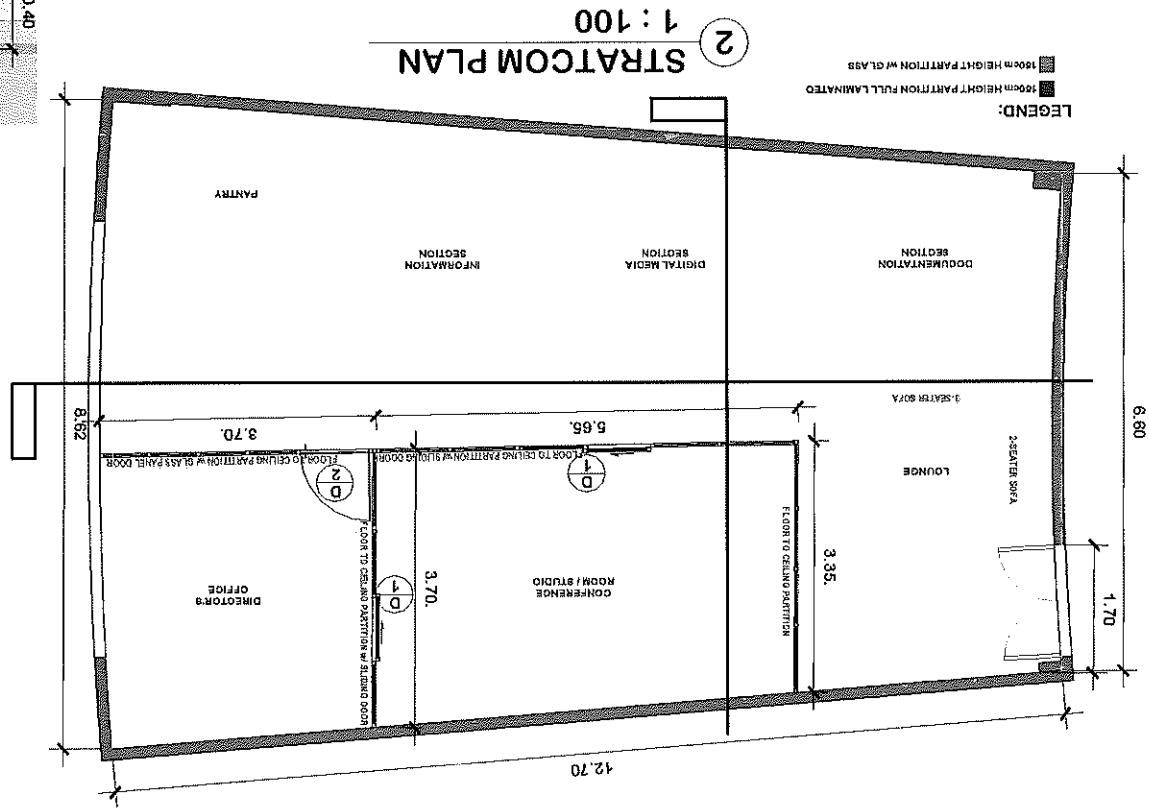

2 STRATCOM PLAN
1 : 100

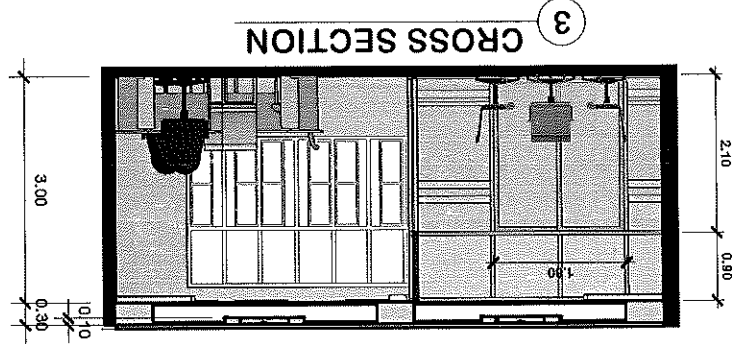

3 CROSS SECTION

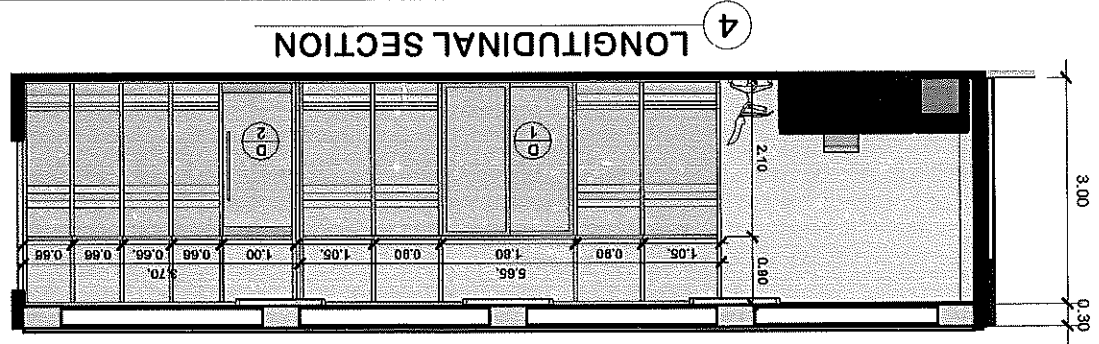

4 LONGITUDINAL SECTION

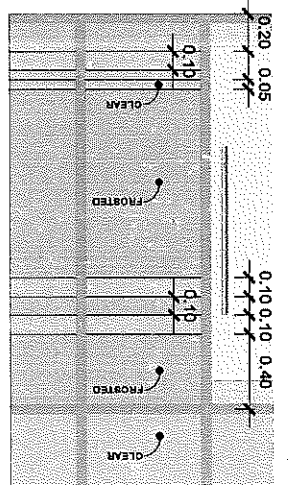

| | | | | |
|--|--|---|--|---|
| PROJECT TITLE: GLASS PARTITION OF OFFICE FOR STRATEGIC COMMUNICATION | | DRAWN BY: EMIR JAN M. MATEO <small>ARCHITECT / DRAFTSMAN II</small> | |  |
| CONFORME: | | PREPARED BY: JEREMIAH ROGER P. CALUYA <small>CIVIL ENGINEER I</small> | | |
| SHEET CONTENT: AS SHOWN | | CHECKED/REVIEWED BY: AIDA V. CABANG <small>ARCHITECT IV, CHIEF-PHYSICAL PLANNING SECTION</small> | | |
| SHEET NO.: | | APPROVED BY: SHIRLEY C. ARRUPIS <small>UNIVERSITY PRESIDENT</small> | | |
| LOCATION: MMSU - FEM HALL BUILDING, CITY OF BATAQ, ILOCOS NORTE | | RECOMMENDING APPROVAL: ROMEO R. BUDOLIAO <small>DIRECTOR, OFFICE FOR STRATEGIC COMMUNICATION</small> | | |

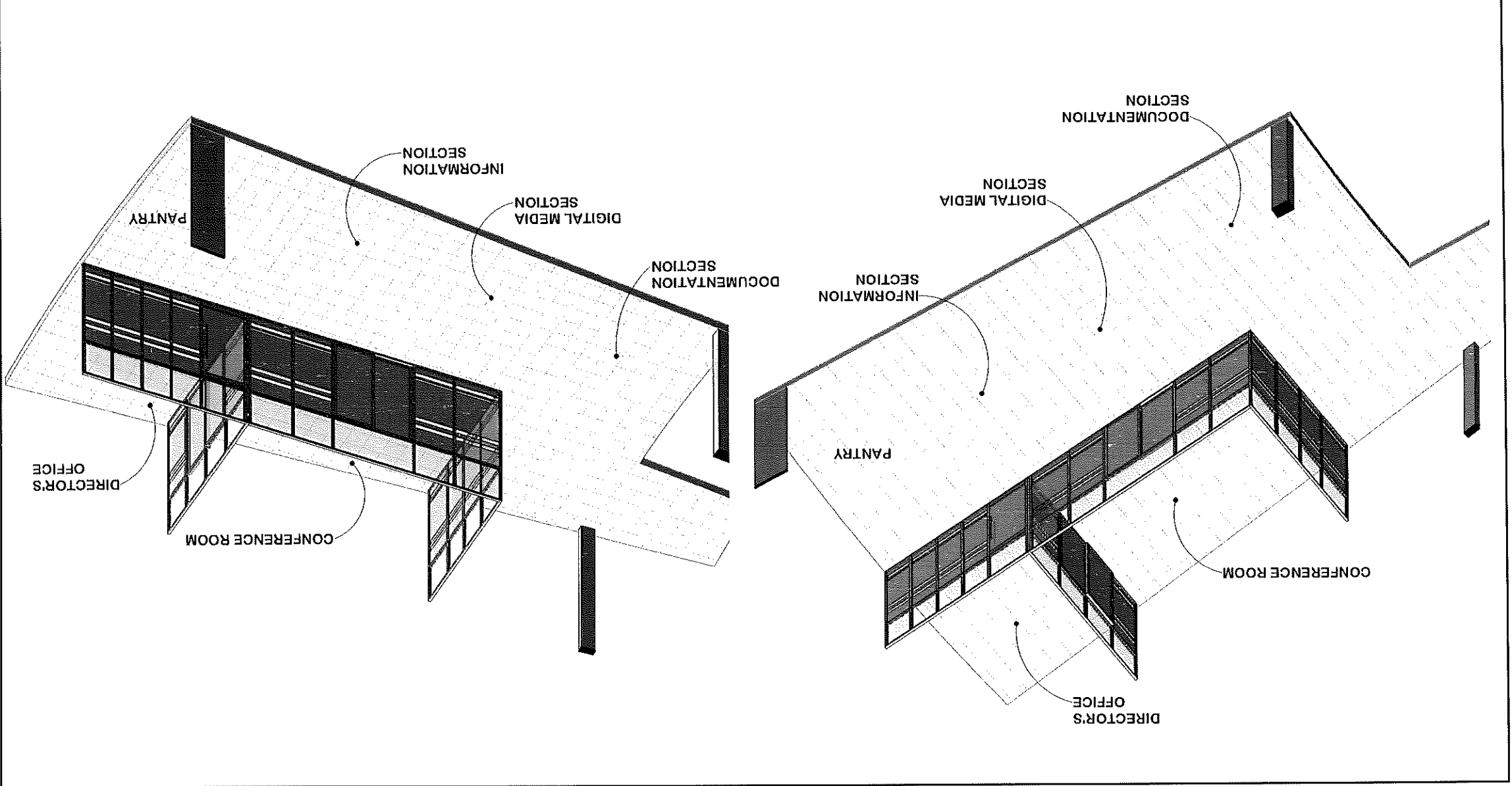



EMIR JAN M. MATEO
ARCHITECT / DRAFTSMAN II

JEREMIAH ROGER P. CALUYA
CIVIL ENGINEER I

DRAWN BY:

PREPARED BY:

PROJECT TITLE:

GLASS PARTITION OF OFFICE FOR
STRATEGIC COMMUNICATION

LOCATION: MMSU - FEM HALL BUILDING, CITY OF BATAO, ILOCOS NORTE

CONFORME:

HERDYL YUMUL
DIRECTOR, OFFICE FOR STRATEGIC COMMUNICATION

RECOMMENDING APPROVAL:

ROMEO R. DUBILAO
DIRECTOR, MMSU

AIDA V. CABANG
ARCHITECT IV, CHIEF-PHYSICAL PLANNING SECTION

SHIRLEY C. AGUIPIS
UNIVERSITY PRESIDENT

APPROVED BY:

AS SHOWN

SHEET CONTENT:

SHEET NO.:

1 STRATCOM REFLECTED CEILING PLAN
1 : 100

